

whangarei art museum

te manawa toi

White Cube Black Box Project 2016
Exhibition proposal | Application form

Applications close 4.30pm Monday 30 May 2016

The Whangarei Art Museum is calling for submissions from curators, artists, designers, art researchers and interested groups to propose an exhibition showcasing local stories and the creative community.

White Cube Black Box Project

After the success of 2015/16 WCBB project with **Simon Kerr: the Roads to Redemption** The Whangarei Art Museum once again welcomes the arts community to share your voice and create an engaging experience for a diverse range of visitors here at the gallery..

The project *White Cube Black Box* introduces the idea of an open blank space of the gallery, often referred to as a 'white cube' space, but also the dynamic and performative element of a 'black box', a term used in theatre to describe a space of story telling and imagination.

This is an opportunity for members of the community to propose an exhibition idea/plan to be displayed at the Whangarei Art Museum over the 2016-17 Spring/Summer period.

What we are looking for

- We encourage well developed exhibition proposals with a strong/clear theme or narrative. It can range from the simple and bold to the subtly thought-provoking, however details, clarity and impact will be important.
- We invite a diverse range of local talent – this can be artists (all mediums welcome) performance artists, designers, aspiring curators or exhibition designers.

NB: The Whangarei Art Museum is a not for profit public art gallery and cannot facilitate commercial art sales. Art works will be on loan for exhibition display only.

The Whangarei Art Museum is entry by donation and does not charge admission.

Final selection of works will be at the discretion of WAM and the exhibition development and installation will be a collaborative process between WAM staff and the successful applicant/s. WAM staff will install the artworks.

About the gallery space

- Running metres (wall space) 34.9m
- Floor space 95.31m³
- Average wall height: 2.55m
- Base wall colour: white

Floor plan:

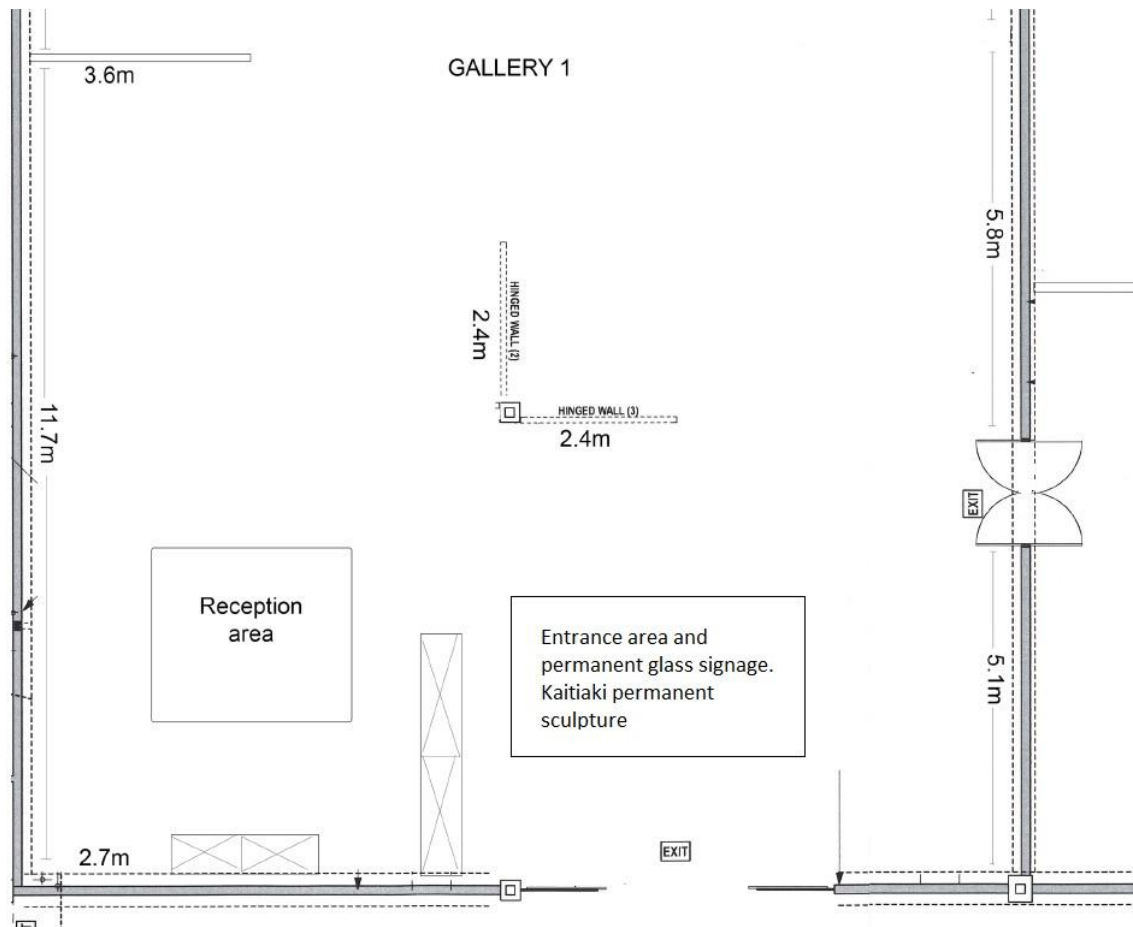

Exhibition dates: 12 December 2016 – 19 February 2017 = 10 week period.

NB: It is recommended that the loan period of art works starts a month before and ends a month after the exhibition dates to allow for packing and transport time.

Installation week: 5-9th December 2016

Deinstallation week: 20-25th February 2017

Exhibition development flow chart